

Trodat B1511+ Flash Exposure System

Manual

Version 1.0

Content

1) Scope of use	2
2) Product safety instructions	2
3) Controls and Functions.....	3
4) Operation.....	4
a) Basic Operation.....	4
b) Loading Stamps for Exposures	5
c) Operation.....	8
5) Maintenance.....	9
6) Additional Information.....	9

Congratulations and thank you for your purchase of Trodat B1511+ flash exposure system. Before you begin using your machine, please read this manual to insure safe and proper operation.

1) Scope of use

The B1511+ flash machine has been designed to quickly and easily expose flash foam text plates in a production environment. After loading the desired artwork, clear protective film and text plate foam, the clamping mechanism will apply the even and precise pressure required for proper exposure of the text plate. The desired energy level will charge the system and properly exposes the text plate foam. The exposed stamp text plates are then ready for immediate use in the assembly in the Ultimark pre-inked stamps.

2) Product safety instructions

- There is high tension electricity inside the machine so that you must not open the machine for avoiding accidents.
- Do not use with non-grounded power sources
- Do not overload wall outlets, extension cords or surge protectors with other devices as this can result in a risk of fire or electrical shock. Power supply cords should be routed so that they are not likely to be walked on or pinched by items placed against them.
- Before opening the case for any type of service procedure, unplug the machine. Electrical repairs should be made only by a licensed electrician familiar with these types of electronics and capacitors.
- Do not place equipment on any surface that is not properly supported for safe operation. This machine should be placed on a sturdy, level and clean work surface. Serious injury to the operator and damage to the equipment can result from poor machine placement. This equipment has been designed to be operated from a flat, level surface.
- This product should be situated away from heat sources and other equipment that may generate excessive vibration, dust or moisture. Avoid exposing unit to sudden temperature changes to prevent condensation inside this unit.

3) Controls and Functions

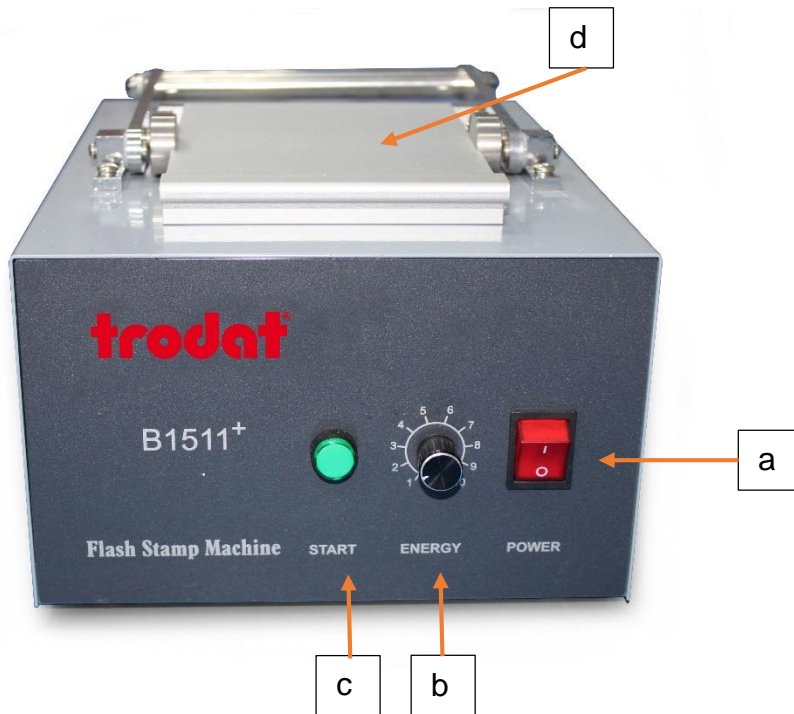

- a. Power switch – press this switch to turn the power on/off to this unit. The switch will be lighted when the unit is turned on. The light will go off when the unit is turned off.
- b. Power Dial – The power dial sets the energy level of the lamps when the exposure is activated
- c. Flash release button – Press the button to execute an exposure. This button is only active with the clamping mechanism in the fully closed and locked position.
- d. Clamping mechanism – This is for the compression of the foam text plates. The top of the clamp evenly applies pressure and compresses the text plate before exposure.

4) Operation

a) Basic Operation

There are three components required in the flash exposure in the Ultimark system. They are (1) the printed artwork, (2) clear protective film and (3) Ultimark text plate.

Printed Artwork Requirements

The artwork for the exposure process should be printed using 600 dots per inch (DPI) laser printer on vellum (Trodats product: VELLUM). The print should be right-reading (positive) and toner side up for use in the Ultimark exposure system. The density of the toner is important to block the light of the print areas. You may need to adjust your print density setting of your printer for optimal performance. See your printer's owner manual.

The text or copy for the stamp should be surrounded by a black printable border that is the same overall size as the text plate that will be exposed. Doing this will allow for easy placement of the text plate during the loading process.

****IMPORTANT**** - When typesetting copy for a layout of stamps for printing on vellum, leave at least a 1/2" (1.27mm) gap (3/4" or 2cm where possible) between stamps in your layout. This is to allow for quick easy placement of text plates and proper exposure. Slightly smaller gaps may be used however having small gaps between stamps will increase the chance of disturbing text plates that have been already placed in the layout.

Clear Protective Film

The clear protective film is placed on top of the printed vellum to separate the artwork from the text plate (Trodats product CLEAR PROTECTIVE FILM). The clear protective film is necessary to prevent the toner from the printed vellum from being deposited on the text plate due to the pressure and heat generated during the exposure process. It is not recommended that printed vellum or clear protective film be reused for this reason.

Ultimark Text Plates

Ultimark text plates have a carefully sealed lip around its perimeter that is captured perfectly within the patented retaining ring of Ultimark Pre-Inked Mounts. One side of the text plate will be sealed with the stamp artwork and the other side will be exposed to the ink cartridge in the assembly of the mount.

b) Loading Stamps for Exposures

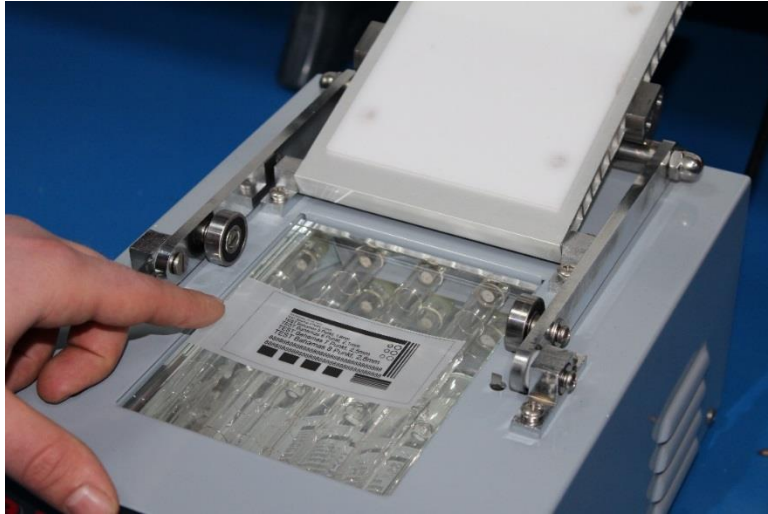

STEP 1 – Place the printed artwork on vellum onto the glass in the exposure area. The vellum should be placed with the toner side facing up and the copy should be right reading (not reversed or mirrored).

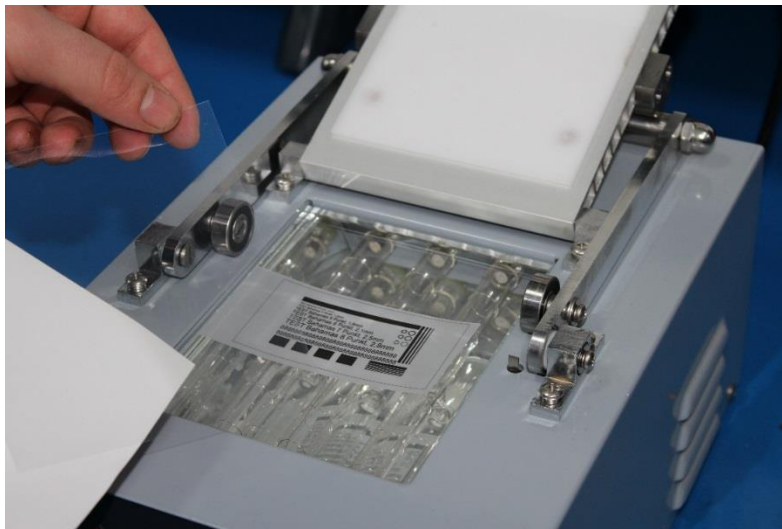

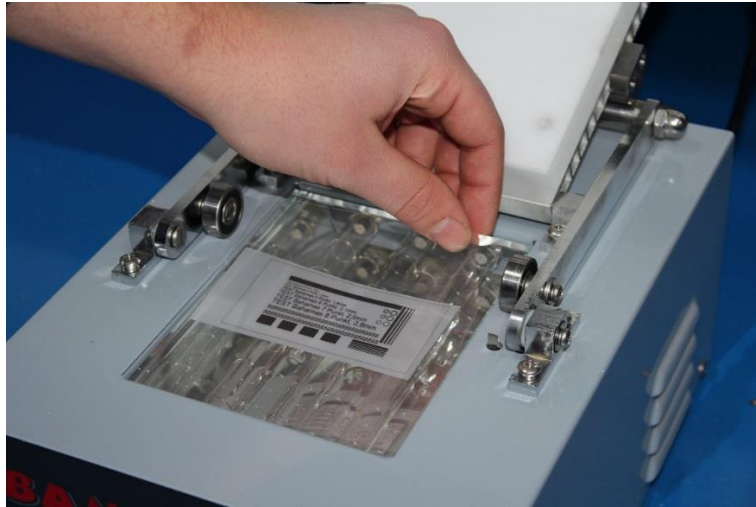

STEP 2 – Place a sheet of clear protective film on top of the vellum in the exposure area.

****TIP**** - Use a piece of removable transparent tape or a 3M Post-It book marking flags to secure the clear protective film to the glass. This will prevent the vellum and clear protective film from sliding when you proceed to the next step. Stapling the clear protective film to the vellum before placement onto the glass is also acceptable.

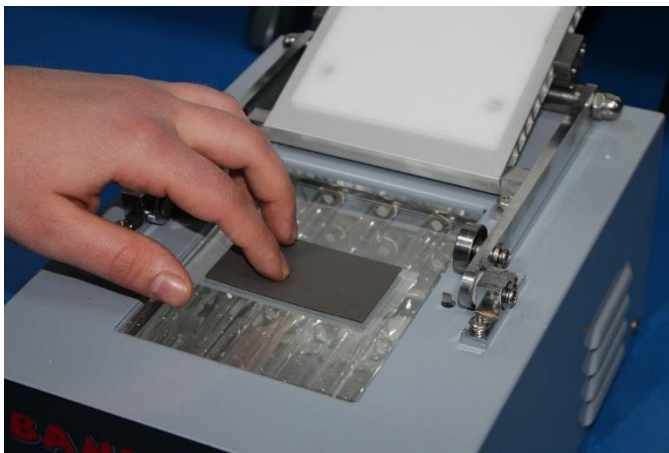
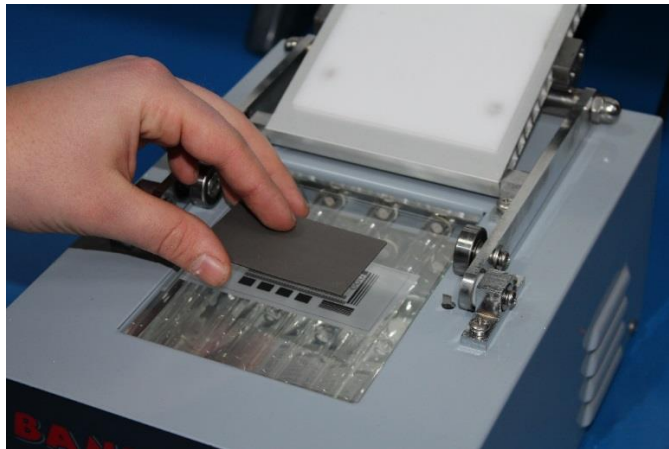

STEP 3 – Gather the appropriately sized text plate(s) for your artwork. Using the black border that you made around your text as a guide, place the text plate with the sealed side down on top of the clear protective film so that the text plate is in the border of your artwork.

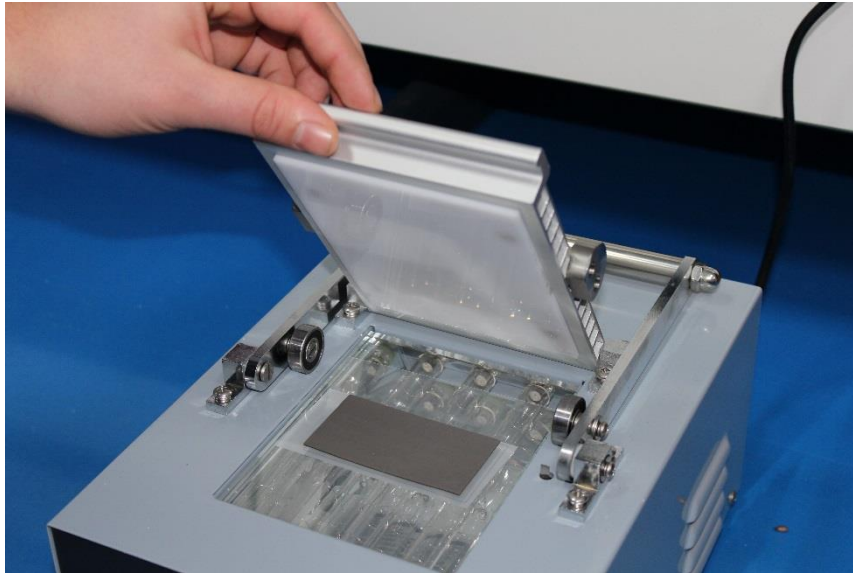

STEP 4 – Close the clamp.

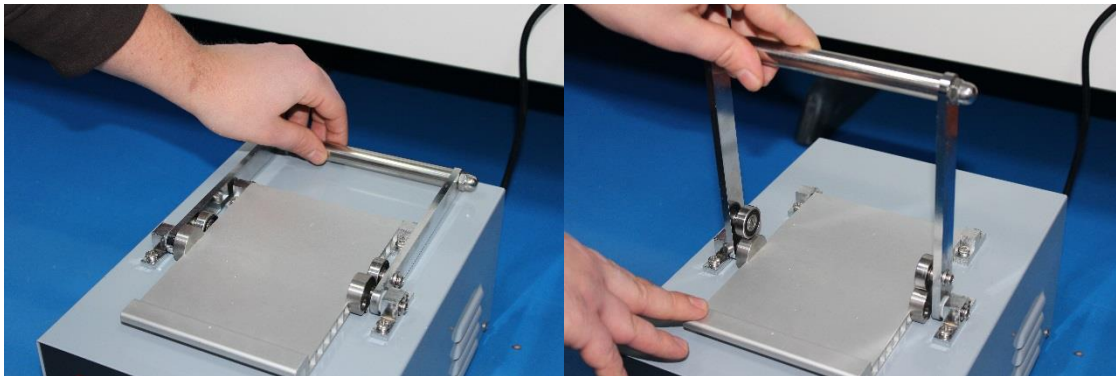

STEP 5 – Grasp the handle of the clamp top and push it into an upright position until the handle meets with resistance and feels locked.

You are now ready to expose the stamp dies.

c) Operation

Perform the following procedure to expose stamp text plates that have been loaded into the exposure unit.

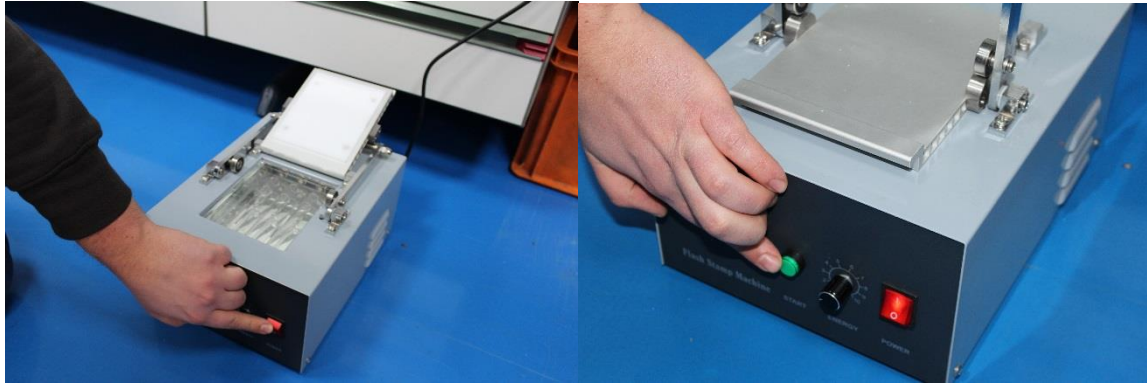

STEP 1 – Turn on the machine. Set the power dial to fix the energy level. **Standard setting is "2"**. Press the **"Start"** button, let expose and then press it a **second time**. This setting may vary depending on the artwork and size of the text plate.

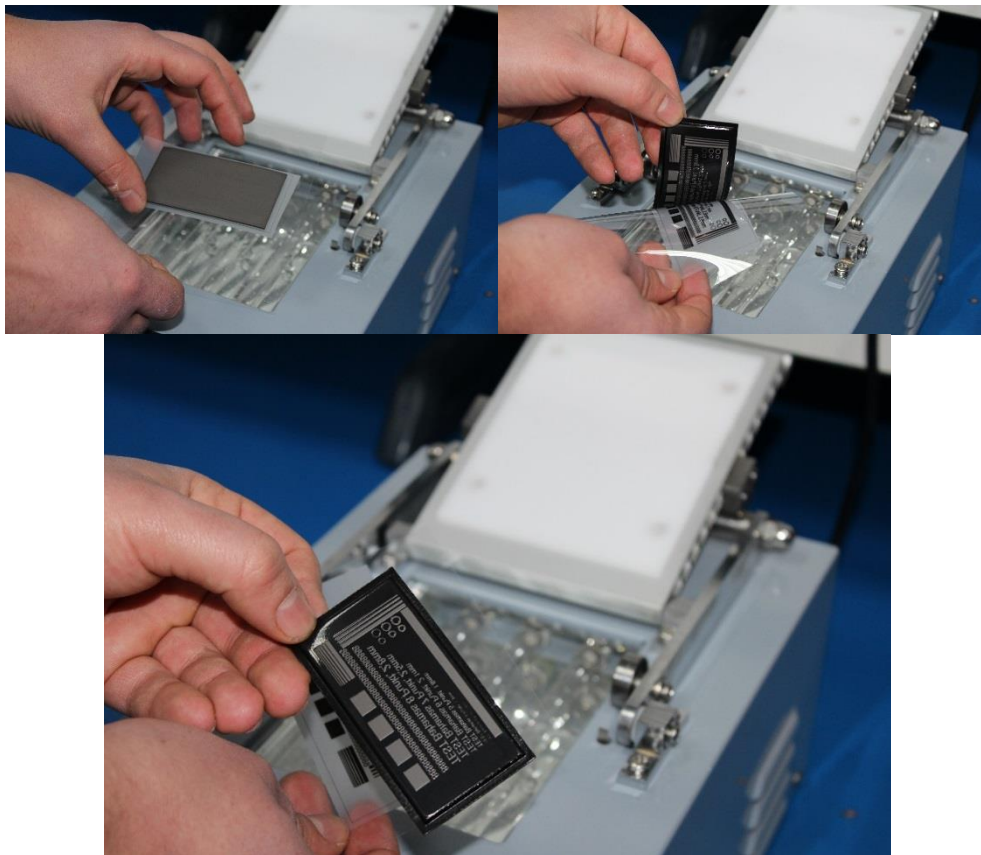

STEP 2 – Open the clamp cover and remove the exposed stamp components. The flashed text plate is now ready to be used in an Ultimark Stamp.

5) Maintenance

Your new B1511+ exposure system has been designed for low maintenance operation as well as ease of use. There are regularly scheduled maintenance requirements consisting of cleaning the glass and clamp compression plate as needed. Please observe the following cleaning tips.

(a) Cleaning the Exposure Glass

Unplug the unit for 10 minutes before performing any operations below. It is very important to keep the glass in the exposure area clean and dust free. This will prevent any possibility of foreign objects interfering with producing a properly exposed stamp die. Clean the glass with any household glass cleaner. Apply glass cleaner to a soft paper towel and then use the towel to clean the glass. Do not spray any cleaners directly on the glass or any other part of the machine.

(b) Cleaning the Machine Body

Unplug the unit for 10 minutes before performing any operations below. Apply water or any mild household cleaner if needed to a soft towel and wipe the surface of the machine (including display) clean. The towel should be damp not wet. Do not use any solvent based cleaners to clean the unit; this may cause damage to the paint or display.

6) Additional Information

Model: B1511+

Quantity of lamps: 3

Exposure area: 150x110mm

Max. exposure energy (J): 420x3

Dimension: 320x240x130mm

Net weight (kg): 9

Total weight (kg): 11

Package Size: 420x300x200